



*The No.1
energy saving equipment
for
ice rinks.*

Partner of



H2oVortex/Watreco, rue d'Anvers, L-1130 Luxembourg
Phone: +352 268468
Web: www.h2ovortex.com www.watreco.com
E-mail: info@h2ovortex.com info@watreco.com



REALice



Energy savings and improved ice quality

This is the second and improved generation of the well known and established REALice system. It consists of two parts: the hand unit, REALice r1x with two nozzles, and one of the three base units, REALice r4x, r6x, or r10x, adapted to different water pressures and flows. The nozzles are used for building the ice foundation and for ice maintenance. The base unit treats the water before filling the resurfacer.

Lower the temperature of added water

The temperature of added water can be lowered below 20°C/68F (cold water) with the REALice system.

Raise ice temperature

Ice temperature can be raised by 1–3°C/2-6F when the ice has been made from REALice water.

Reduce hot water consumption

As REALice is used when resurfacing the ice, you can drastically reduce your hot water consumption.

Improve ice quality

Ice made from water that has been treated by REALice becomes better, faster, and more durable.

Save Euros/Dollars

Lowered water temperature in the resurfacer and slightly warmer ice reduces the required cooling, compressors last longer and you save energy and money. The saving is around 10 000 per year.

Lower viscosity

The REALice system will lower the viscosity of the water, entailing that it flows out more easily despite the temperature being lower.

Reduced limescale deposits

REALice changes the chemical balances of hard water in such a way that lime scaling is reduced on surfaces. Equipment lasts longer and does not require maintenance as often as before.

www.realice.ca / www.realice.us

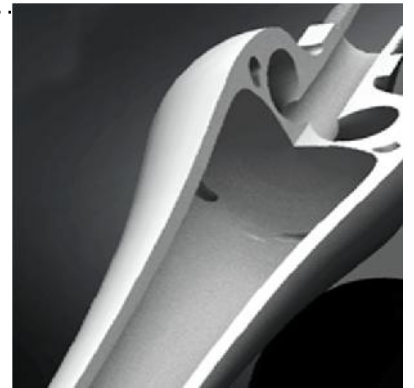

Technical specification

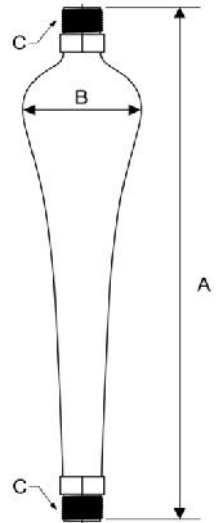
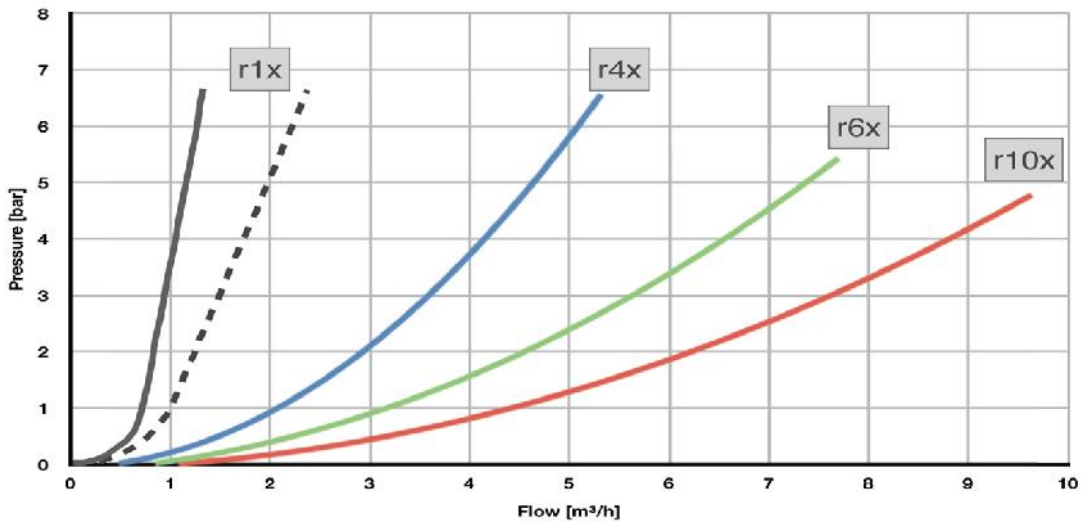

	r1x	r4x	r6x	r10x
Max pressure @ 20°C/68F	16 bar / 232 PSI (PN16)	16 bar / 232 PSI (PN16)	16 bar / 232 PSI (PN16)	16 bar / 232 PSI (PN16)
Normal flow @ 4 - 5 bar 58-75psi	1 - 2 m³/h 264 - 528 gal/h	4 m³/h 1057 gal/h	6 m³/h 1585 gal/h	10 m³/h 2642 gal/h
Recommended operational temperature	18°C / 64 F	18°C / 64 F	18°C / 64 F	18°C / 64 F
Length (A)	340mm/13.39"	558mm/21.97"	643mm/25.32"	726mm/28.58"
Diameter (B)	106mm/4.17"	82mm/3.23"	96mm/3.78"	120mm/4.73"
Weight	0,97 kg 2,14 lb	1,27 kg 2,80 lb	1,43 kg 3,15 lb	1,89 kg 4,17 lb
Connect to: (C)	ISO 228-G1"	ISO 228-G1"	ISO 228-G1"	ISO 228-G1¼"
Pressure meter	No	Yes	Yes	Yes





REALIce r1x - Hand Unit

The hand unit REALIce r1x is used when building the ice for the first time and for repair and maintenance.

Hose

Attach the REALIce r1x at the end of the hose used for repair and maintenance of the ice. Use it at all times for optimal energy saving and ice quality.

Two nozzles

You can choose between two nozzles for different water flow.

Realice r4x, r6x, r10x - Base Unit

Close to the tap station for the ice resurfacer, one of the three base units, REALIce r4x, r6x or r10x, will be installed to fill the ice resurfacer prior to resurfacing.

Piping

Install the REALIce base unit at the piping and fix it to the wall before and after the REALIce unit.

Pressure meter

Use the pressure meter to see the maximum water flow that is possible to get out from your water system when the REALIce unit is installed at a certain pressure. Make a straight line from the pressure value and the measured water flow in the system, taken without the REALIce base unit installed. Check the flow value in the diagram where the lines are crossing at your corresponding REALIce unit. (See technical specification)





REALIce r1x - Hand Unit

Two nozzles

The hand unit, REALIce r1x, comes with two nozzles for different water flow, to use when building the ice for the first time and for repair and maintenance. The hand unit will create a very fine mist that will freeze in thin layers. For best result, point the REALIce r1x upwards, in a 45 degree angle and move it from left to right.

Cold water

Always use cold water, below 20°C/68°F when building and maintaining the ice with the hand unit.

Building the ice for the first time

Use the REALIce r1x to make thin layers of water and let it freeze before the next layer of water is added. Build the ice for approximately 5mm/0.015" or until you can enter the ice with the ice resurfacer.

Ice repair and maintenance

Choose between two nozzles for different water flow when repairing or maintaining the ice. Always let the ice freeze in thin layers for best result.

REALIce r4x, r6x, r10x - Base Unit

Cold water

Always use cold water when using the REALIce r4x, r6x, r10x unit. Normally below 20°C/68°F.

Filling up the ice resurfacer

Fill up the ice resurfacer as close to ice resurfacing as possible for best result. The effect of REALIce treatment will stay in the water for a minimum of 24 hours.

Ice resurfacer speed

Take your time when resurfacing the ice. A normal resurfacing of the ice will take about 10 minutes. Slow down in the curves.

Ice temperature

When using REALIce you can normally raise the ice temperature 1-3°C/2-6°F.

Ice thickness

Ice thickness can be decreased to approximately 30mm/0.09" due to the harder and more durable ice, produced by REALIce treated water.

Humidity

Optimal humidity in the ice arena is around 50-55%.





Warranty

The warranty cover:

- The product is warranted for 5 (five) years from the date of delivery.
- Watreco warrants that on delivery the product is free of faults in materials, manufacturing and function.
- Watreco warrants that the product is identifiable on delivery.
- The warranty covers all types of fault which may arise in normal use of the product.
- Under the warranty, Watreco or its representative will mend the damaged product or replace it with a new one free of charge.
- In the event of a claim under the warranty, Watreco's representative should be contacted in the first instance. Watreco may be contacted in the second instance.
- Watreco or its representative will decide whether the product is to be mended or replaced.
- Where the damaged product is to be replaced, the product should be returned to Watreco's representative for inspection in the first instance. The customer is to pay the shipping costs. The product may be sent to Watreco in the second instance.
- The replacement component will, in the first instance, be shipped free of charge from the warehouse of Watreco's representative, or from Watreco if necessary.

The warranty does not cover:

- Cases where the product has been changed, modified or opened.
- Cases where the product has not been used in accordance with the instructions.
- Cases where the product has not been installed in accordance with the installation instructions.
- Cases where the product has been used for a purpose other than that for which it was intended.
- Cases where the label identifying the product has been removed.
- Cases where the product has been subjected to pressure or temperature exceeding that set out in the instructions or the values stated on the product.
- Cases where the internal channels in the unit is clogged by particles in the water.
- Cases where the damage has arisen through external force such as hitting, bending or twisting.
- Damage which may arise to other property or persons due to the product or deficiencies in the product.
- Other costs which may arise due to the product or deficiencies in the product.
- Any costs, charges or taxes which may arise when replacing the product.
- Costs arising for removing and installing the product.

